

User's Manual

AL7000 is intended to measure alcohol in human breath. Readings obtained by this device are used in the diagnosis of alcohol intoxication.

The accuracy of this device has been established at a Blood Alcohol Concentration of 0.000 to 0.400%BAC.

Accuracy testing was completed according to DOT regulations.

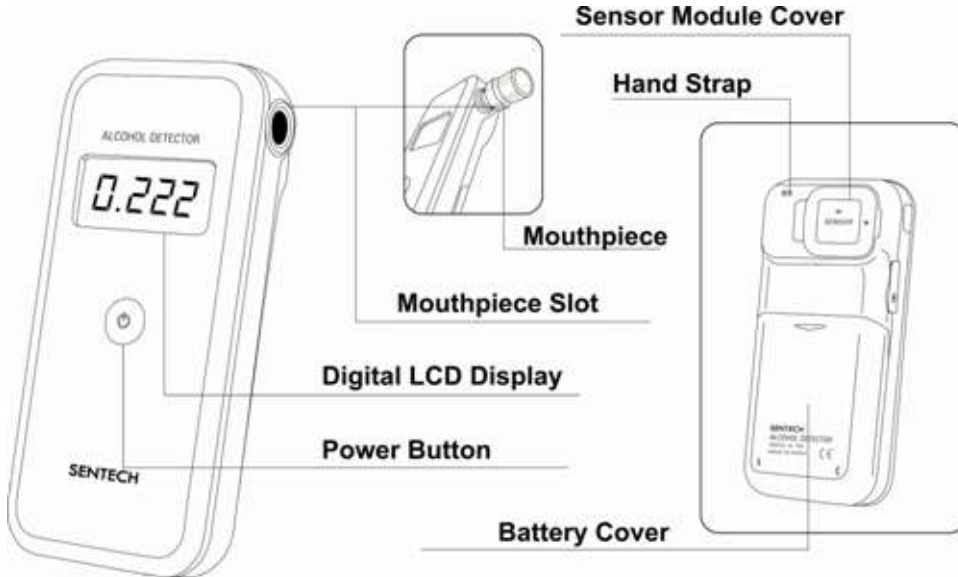

The AlcoScan Model AL7000 analyzes a breath sample to detect alcohol in the lungs.

This reading is then converted to blood alcohol concentration (BAC).

AL7000 uses an advanced oxide semiconductor sensor to detect alcohol.

Specifications

Method of Measure	Breath sample to BAC
Range	0.000 to 0.400%BAC or 0.000 to 4.000‰ or 0.000 to 2.000mg/l BrAC
Accuracy	+/-0.01%BAC up to 0.10%BAC
Sensor	Oxide semiconductor
Power	Two 1.5V AA alkaline batteries (included)
Testing Capacity	Approx. 100~200 with new batteries
Operating Temperature	10 – 40 degrees Celsius
Warm Up	Less than 1 minute
Display	3-digit LCD
Size (mm)	105(height) X 50(width) X 18(thickness)
Weight	98g
Sensor Modules	Sensor modules should be replaced approx. 300 tests, or if damaged by improper testing or handling

How to use

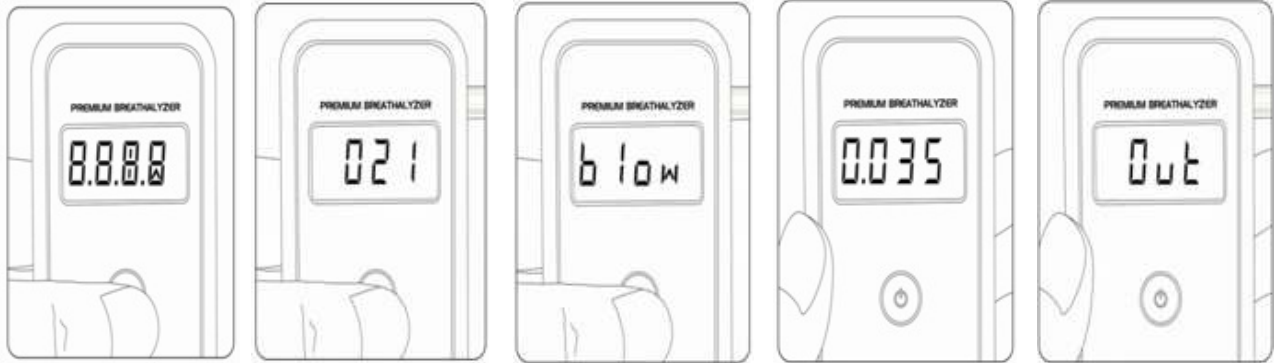

Press the power switch.

Warm up.

Blowing through the mouthpiece into the unit for 4 seconds until beep twice.

The result is displayed for 15 seconds.

Automatically turning off.

* If you keep press and hold the power switch, you can check the accumulated total test

AL7000 is the breathalyzer that features Pre-Calibrated Alcohol Sensor Modules to eliminate the need for recalibration.

Just snap out, snap in and you're ready to go!

Sensor Module Replacement

Please take the following steps to install new sensor module. (★ You have to turn off the power first)

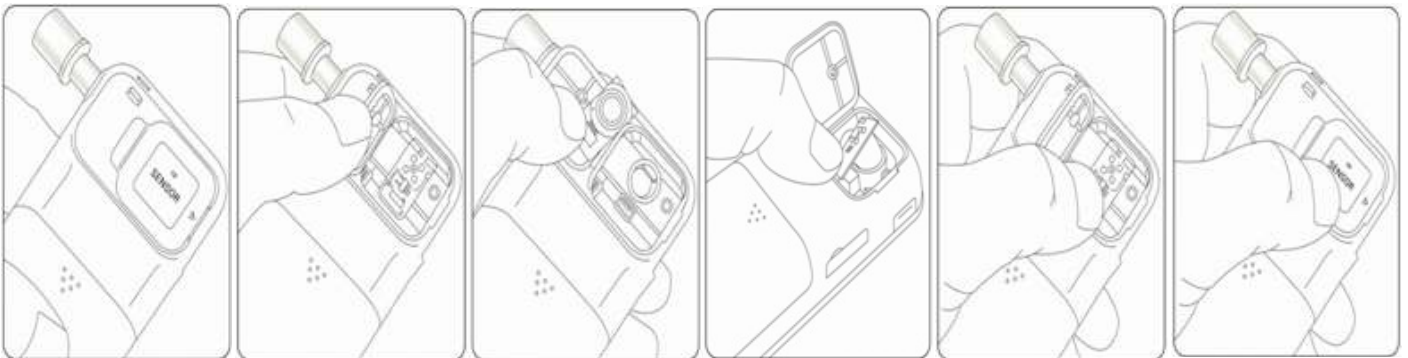

Open the sensor cover.

You can see the sensor module.

Take off PCB.

Replace the new sensor module into original position.

Make sure the module is connected tightly.

Close the sensor cover then test.

Warnings

- a. Wait at least 20 minutes after eating or drinking before testing. Alcohol remaining in the mouth, or even excess saliva, may interfere with testing. This includes alcohol-based mouthwash or similar products.
 - b. Avoid testing in high wind or enclosed spaces. Poor ventilation may also lengthen the time required for warm up between tests.
 - c. Do not blow smoke, saliva or other contaminants into the mouthpiece, as the sensor may become damaged.
 - d. **Do NOT use the AL7000 as a tool to drink and drive.**
 - e. Keep out of extreme temperatures and out of the reach of children.
-

Warning Display



If you see "Flow" in the display, the breath sample was not strong enough for measurement. Please power on the unit again and make sure the breath is strong and steady during sampling.



If you test over 300 tests, AL7000 will display "CAL" sign for 15 seconds then warning up for test. This "CAL" sign will be provided the appropriate time for calibration or replacement sensor module.



If you see "bat" in the display, the battery power is low. Please replace the batteries.

Contents

Breathalyzer, Mouthpieces(x5), AA Batteries(x2), Pouch, Hand strip, 12V DC code and manual

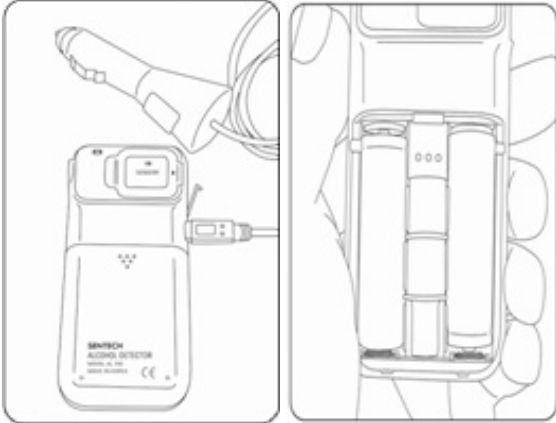

12V Alternative Power

You can use alternative power from car cigar jack lighter with provided cable.

Mouthpiece Holder

It can keep 2pcs mouthpieces inside of breathalyzer.

Warranty

The manufacturer warrants the product to be free from defects in workmanship or material (excluding calibration) under normal use for six (6) months from the date of purchase.

The manufacturer's obligation under this warranty is limited to replacing, adjusting or repairing the unit if returned along with proof of purchase. This warranty is void if the unit has been tampered with or maliciously damaged.

Recalibration & Service

For recalibration and technical support, please contact us at: